

**City of Garden Grove**

**INTER-DEPARTMENTAL MEMORANDUM**

|          |   |        |                   |
|----------|---|--------|-------------------|
| To:      | Matthew J. Fertal   | From:  | William E. Murray |
| Dept.:   | City Manager  | Dept.: | Public Works      |
| Subject: | APPROVAL OF AN AGREEMENT WITH<br>IWATER, INC. FOR OPERATION OF<br>WATER GATE VALVES | Date:  | May 14, 2013      |

**OBJECTIVE**

To request that the City Council approve an agreement with iWater, Inc. to provide all labor and traffic control for the operation of water gate valves at various locations in the city of Garden Grove in the amount of \$597,400.

**BACKGROUND**

The City currently has 10,300 water valves ranging in size from 4" to 8" in all residential streets throughout Garden Grove that are serviced every 2 years. In order for water personnel to continue focusing on needed capital improvements, an outside contractor is required to perform this service.

**DISCUSSION**

iWater has the expertise to operate the water valves and provides reports on valve operating conditions (i.e. closed, broken or worn valves). This information will be transferred to the GIS (Graphic Information System) for future replacements and other field data updates.

The request for proposals for the water valve operation was advertised on February 15, 2013, and again on February 22, 2013, on the City's website. There were eight prospective bidders; two companies attended the mandatory pre-bid meeting on February 27, 2013, and one responsive proposal was received and opened on March 20, 2013. City staff reviewed the proposal and negotiated a contract with iWater, Inc. It was decided to proceed with iWater's proposal due to the reasonableness of their unit costs provided, proximity to Garden Grove, and positive references.

**FINANCIAL IMPACT**

There is no impact to the General Fund. The project will use Water Funds in the amount of \$597,400.

APPROVAL OF AN AGREEMENT WITH IWATER, INC. FOR OPERATION OF  
WATER GATE VALVES

May 14, 2013

Page 2

RECOMMENDATION

It is recommended that the City Council:

- Award the contract to iWater, Inc. for the operation of water gate valves at various locations in the city, in the amount of \$597,400; and
- Authorize the City Manager to execute the agreement with iWater, Inc. on behalf of the City.



WILLIAM E. MURRAY, P.E.  
Public Works Director/City Engineer

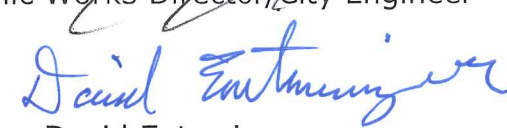

By: David Entsminger  
Water Services Manager

Attachment: Agreement

**Recommended for Approval**



**Matthew Ferial**  
City Manager

**SECTION 4 - AGREEMENT****PROJECT AGREEMENT**

**THIS AGREEMENT** is made this \_\_\_\_\_ day of \_\_\_\_\_, 2013, by the CITY OF GARDEN GROVE, a municipal corporation, ("CITY"), and **iWater, Inc.**, hereinafter referred to as ("CONTRACTOR").

**RECITALS:**

The following recitals are a substantive part of this Agreement:

This Agreement is entered into pursuant to Garden Grove COUNCIL AUTHORIZATION, DATED \_\_\_\_\_.

CITY desires to utilize the services of CONTRACTOR to Provide all Labor and Traffic Control for the operation of 10,300 Water Gate Valves at various residential locations in the City of Garden Grove.

CONTRACTOR is qualified by virtue of experience, training, education, and expertise to accomplish services.

**AGREEMENT**

THE PARTIES MUTUALLY AGREE AS FOLLOWS:

- 4.0 **Compensation.** CONTRACTOR shall be compensated as follows:  
 Compensation under this agreement shall be a Firm Fixed Price (FFP) in the amount of Five Hundred Ninety Seven Thousand Four Hundred Dollars (\$597,400.00) payable in arrears. Payment for work under this Agreement shall be made per invoice for work completed. All work shall be in accordance with Bid No. S-1117 and the Scope of Work (Attachment "A").
- 4.1 **General Conditions.** CONTRACTOR certifies and agrees that all the terms, conditions and obligations of the Contract Documents as hereinafter defined, the location of the job site, and the conditions under which the work is to be performed have been thoroughly reviewed, and enters into this Contract based upon CONTRACTOR'S investigation of all such matters and is in no way relying upon any opinions or representations of CITY. It is agreed that this Contract represents the entire agreement. It is further agreed that the Contract Documents including the Notice Inviting Bids, Special Instructions to Bidders, if any, and Contractor's Proposal, are incorporated in this Contract by reference, with the same force and effect as if the same were set forth at length herein, and that CONTRACTOR and its subcontractors, if any, will be and are bound by any and all of said Contract Documents insofar as they relate in any part or in any way, directly or indirectly, to the work covered by this Contract.

**"Project"** as used herein defines the entire scope of the work covered by all the Contract Documents. Anything mentioned in the Specifications and not indicated in the Plans, or indicated in the Plans and not mentioned in the Specifications, shall be of like effect as if indicated and mentioned in both. In case of discrepancy in the Plans or Specifications, the matter shall be immediately submitted to City's Engineer, without whose decision CONTRACTOR shall not adjust said discrepancy save only at CONTRACTOR'S own risk and expense. The decision of the Engineer shall be final.

**4.2 Materials and Labor.** CONTRACTOR shall furnish, under the conditions expressed in the Plans and Specifications, at CONTRACTOR'S own expense, all labor and materials necessary, except such as are mentioned in the Specifications to be furnished by the CITY, to complete the project, in good workmanlike and substantial order. If CONTRACTOR fails to pay for labor or materials when due, CITY may settle such claims by making demand upon the surety to this Agreement. In the event of the failure of refusal of the surety to satisfy said claims, CITY may settle them directly and deduct the amount of payments from the Contract price and any amounts due to CONTRACTOR. In the event CITY receives a stop notice from any laborer or material supplier alleging non-payment by CONTRACTOR, CITY shall be entitled to deduct all of its costs and expenses incurred relating thereto, including but not limited to administrative and legal fees.

**4.3 Project.** The **PROJECT is described as:** Provide all Labor and Traffic Control for the operation of 10,300 Water Gate Valves at various locations in the City of Garden Grove.

**4.4 Plans and Specifications.** The work to be done is described in a set of detailed Plans and Specifications entitled: Provide all Labor and Traffic Control for the operation of 2,203 Water Gate Valves at various locations in the City of Garden Grove. Said Plans and Specifications and any revisions, amendments or addenda thereto are attached hereto and incorporated herein as part of this Contract and referred to by reference. The work to be done must also be in accordance with the General Provisions, Standard Specifications and Standard Plans of City which are also incorporated herein and referred to by reference.

**4.5 Time of Commencement and Completion.** CONTRACTOR agrees to commence the Project with TEN (10) calendar days from the date set forth in the "Notice to Proceed" sent by City and shall diligently prosecute the work to completion within **24 months** from commencement of work excluding delays caused or authorized by the CITY as set forth in Sections 4.7, 4.8 and 4.9 hereof. The completion dates shall include any material delivery.

**4.6 Time is of the Essence.** Time is of the essence of this Contract. As required by the Contract Documents, CONTRACTOR shall prepare and obtain approval of all shop drawings, details and samples, and do all other things necessary and incidental to the prosecution of CONTRACTOR'S work in conformance with an approved construction progress schedule. CONTRACTOR shall coordinate the

work covered by this Contract with that of all other contractors, subcontractors and of the CITY, in a manner that will facilitate the efficient completion of the entire work in accordance with Section 4.5 herein. CITY shall have complete control of the premises on which the work is to be performed and shall have the right to decide the time or order in which the various portions of the work shall be installed or the priority of the work of other subcontractors, and, in general, all matters representing the timely and orderly conduct of the work of CONTRACTOR on the premises.

- 4.7 Excusable Delays.** CONTRACTOR shall be excused for any delay in the prosecution or completion of the Project caused by acts of God; inclement weather; damages caused by fire or other casualty for which CONTRACTOR is not responsible; and act, neglect or default of CITY; failure of CITY to make timely payments to CONTRACTOR; late delivery of materials required by this CONTRACT to be furnished by CITY; combined action of the workers in no way caused by or resulting from default or collusion on the part of CONTRACTOR; a lockout by CITY; or any other delays unforeseen by CONTRACTOR and beyond CONTRACTOR'S reasonable control.

City shall extend the time fixed in Section 4.5 herein for completion of the Project by the number of days CONTRACTOR has thus been delayed, provided that CONTRACTOR presents a written request to CITY for such time extension within fifteen (15) days of the commencement of such delay and CITY finds that the delay is justified. CITY'S decision will be conclusive on the parties to this Contract. Failure to file such request within the time allowed shall be deemed a waiver of the claim by CONTRACTOR.

No claims by CONTRACTOR for additional compensation or damages for delays will be allowed unless CONTRACTOR satisfies CITY that such delays were unavoidable and not the result of any action or inaction of CONTRACTOR and that CONTRACTOR took all available measures to mitigate such damages. Extensions of time and extra compensation as a result of incurring undisclosed utilities will be determined in accordance with Section 9-103A of the State of California Department of Transportation Standard Specifications. The CITY'S decision will be conclusive on all parties to this Contract.

- 4.8 Extra Work.** The Contract price includes compensation for all work performed by CONTRACTOR, unless CONTRACTOR obtains a written change order signed by a designated representative of CITY specifying the exact nature of the extra work and the amount of extra compensation to be paid all as more particularly set forth in Section 4.9 hereof. CITY shall extend the time fixed in Section 4.5 for completion of the Project by the number of days reasonably required for CONTRACTOR to perform the extra work, as determined by CITY'S Engineer. The decision of the Engineer shall be final.

**4.9 Changes in Project.**

- 4.9.1** CITY may at any time, without notice to any surety, by written order designated or indicated to be a change order, make any change in the

work within the general scope of the Contract, including but not limited to changes:

- a. in the Specifications (including drawings and designs);
- b. in the time, method or manner of performance of the work;
- c. in the City-furnished facilities, equipment, materials, services or site; or
- d. directing acceleration in the performance of the work.

**4.9.2** A change order shall also be any other written order (including direction, instruction, interpretation or determination) from the CITY which causes any change, provided CONTRACTOR gives the CITY written notice stating the date, circumstances and source of the order and that CONTRACTOR regards the order as a change order.

**4.9.3** Except as provided in this Section 4.9, no order, statement or conduct of the CITY or its representatives shall be treated as a change under this Section 9 or entitle CONTRACTOR to an equitable adjustment.

**4.9.4** If any change under this Section 4.9 causes an increase or decrease in CONTRACTOR'S actual, direct cost or the time required to perform any part of the work under this Contract, whether or not changed by any order, the CITY shall make an equitable adjustment and modify the Contract in writing. Except for claims based on defective specifications, no claim for any change under paragraph (4.9.2) above shall be allowed for any costs incurred more than 20 days before the CONTRACTOR gives written notice as required in paragraph (4.9.2). In the case of defective specifications for which the CITY is responsible, the equitable adjustment shall include any increased direct cost CONTRACTOR reasonably incurred in attempting to comply with those defective specifications.

**4.9.5** If CONTRACTOR intends to assert a claim for an equitable adjustment under this Section 4.9, it must, within thirty (30) days after receipt of a written change order under paragraph (4.9.1) or the furnishing of a written notice under paragraph (4.9.2), submit a written statement to the CITY setting forth the general nature and monetary extent of such claim. The CITY may extend the 30-day period. CONTRACTOR may include the statement of claim in the notice under paragraph (4.9.2) of this Section 4.9.

**4.9.6** No claim by CONTRACTOR for an equitable adjustment shall be allowed if made after final payment under this Agreement.

**4.9.7** CONTRACTOR hereby agrees to make any and all changes, furnish the materials and perform the work that CITY may require without nullifying this Contract. CONTRACTOR shall adhere strictly to the Plans and Specifications unless a change there from is authorized in writing by the CITY. Under no condition shall CONTRACTOR make any changes to the

Project, either in additions or deduction, without the written order of the CITY and the CITY shall not pay for any extra charges made by CONTRACTOR that have not been agreed upon in advance in writing by the CITY. CONTRACTOR shall submit immediately to the CITY written copies of its firm's cost or credit proposal for change in the work. Disputed work shall be performed as ordered in writing by the CITY and the proper cost or credit breakdowns therefore shall be submitted without delay by CONTRACTOR to CITY.

**4.10 Liquidated Damages for Delay.** The parties agree that if the total work called for under this Contract, in all parts and requirements, is not completed within the time specified in Section 4.5 herein, plus the allowance made for delays or extensions authorized under Section 4.7, 4.8 and 4.9 herein, the CITY will sustain damage which would be extremely difficult and impractical to ascertain. The parties therefore agree that CONTRACTOR will pay to CITY the sum of two hundred and fifty dollars (\$250.00) per day for each and every calendar day during which completion of the Project is so delayed. CONTRACTOR agrees to pay such liquidated damages and further agrees that CITY may offset the amount of liquidated damages from any moneys due or that may become due CONTRACTOR under the Contract.

**4.11 Contract Price and Method of Payment.** CITY agrees to pay and the CONTRACTOR agrees to accept as full consideration for the faithful performance of this Contract, subject to any subsequent additions or deductions as provided in approved change orders, the sum as itemized in the bid proposal.

Progress payments shall be made to the CONTRACTOR per month for each successive month as the work progresses. The CONTRACTOR shall be paid such sum as will bring the total payments received since the commencement of the work up to ninety percent (90%) of the value of the work completed, less all previous payments, provided that the CONTRACTOR submits the request for payment prior to the end of the day required to meet the payment schedule. The CITY will retain ten percent (10%) of the amount of each such progress estimate and material cost until 30 days after the recordation of the Notice of Completion.

Payments shall be made on demands drawn in the manner required by law, accompanied by a certificate signed by the CITY'S Engineer, stating that the work for which payment is demanded has been performed in accordance with the terms of the Contract. Partial payments of the Contract price shall not be considered as an acceptance of any part of the work.

**4.12 Substitution of Securities in Lieu of Retention of Funds.** Pursuant to California Public Works Contract Code Section 22300, the CONTRACTOR will be entitled to post approved securities with the CITY or an approved financial institution in order to have the CITY release funds retained by the CITY to ensure performance of the Contract. CONTRACTOR shall be required to

execute an addendum to this Contract together with escrow instructions and any other documents in order to effect this substitution.

**4.13 Completion.** CITY may require affidavits or certificates of payment and/or releases from any subcontractor, laborer or material supplier in connection with Stop Notices which have been filed under the provisions of the statutes of the State of California.

**4.14 Contractor's Employee Compensation.**

**4.14.1 General Prevailing Rate.** CITY has ascertained from the State of California Director of Industrial Relations, the general prevailing rate of per diem wages and the general prevailing rate for legal holiday and over time work in the locality in which the work is to be performed for each craft or type of work needed to execute this Contract, and copies of the same are on file in the Office of the City Engineer. The CONTRACTOR agrees that not less than said prevailing rates shall be paid to workers employed on this public works contract as required by Labor Code Section 1774 of the State of California.

**4.14.2 Forfeiture for Violation.** CONTRACTOR shall, as a penalty to the CITY, forfeit fifty dollars (\$50.00) for each calendar day or portion thereof for each worker paid (either by the CONTRACTOR or any subcontractor under it) less than the prevailing rate of per diem wages as set by the Director of Industrial Relations, in accordance with Sections 1770-1780 of the California Labor Code for the work provided for in this Contract, all in accordance with Section 1775 of the Labor Code of the State of California.

**4.14.3 Travel and Subsistence Pay.** Section 1773.8 of the Labor Code of the State of California, regarding the payment of travel and subsistence payments, is applicable to this Contract and CONTRACTOR shall comply therewith.

**4.14.4 Apprentices.** Section 1777.5, 1777.6 and 1777.7 of the Labor Code of the State of California, regarding the employment of apprentices is applicable to this Contract and the CONTRACTOR shall comply therewith if the prime contract involves thirty thousand dollars (\$30,000.00) or more or twenty (20) working days, or more; or if contracts of specialty contractors not bidding for work through the general or prime contractor are two thousand dollars (\$2,000.00) or more for five (5) working days or more.

**4.14.5 Workday.** In the performance of this Contract, not more than eight (8) hours shall constitute a day's work, and CONTRACTOR shall not require more than eight (8) hours of labor in a day from any person employed by him there under except as provided in paragraph (4.14.2) above. CONTRACTOR shall conform to Article 3, Chapter 1, Part 7 (Sections



1810 et seq.) of the Labor Code of the State of California and shall forfeit to the CITY as a penalty, the sum of twenty-five dollars (\$25.00) for each worker employed in the execution of this Contract by CONTRACTOR or any subcontractor for each calendar day during which any worker is required or permitted to labor more than eight (8) hours in any one calendar day and forty (40) hours in any one week in violation of said Article. CONTRACTOR shall keep an accurate record showing the name and actual hours worked each calendar day and each calendar week by each worker employed by CONTRACTOR in connection with the Project.

**4.14.6 Records of wages: Inspection.** CONTRACTOR agrees to maintain accurate payroll records showing the name, address, social security number, work classification, straight-time and overtime hours worked each day and week, and the actual per diem wages paid to each journeyman, apprentice, worker or other employee employed by it in connection with the Project and agrees to require that each of its subcontractors does the same. All payroll records shall be certified as accurate by the applicable contractor or subcontractor or its agent have authority over such matters. CONTRACTOR further agrees that its payroll records and those of its subcontractors shall be available to the employee or employee's representative, the Division of Labor Standards Enforcement, and the Division of Apprenticeship Standards and shall comply with all the provisions of Labor Code Section 1776, in general.

**4.15 Surety Bonds.** CONTRACTOR shall, upon entering into performance of this Agreement, furnish bonds in the amount of one hundred percent (100%) of the Contract price bid, to guarantee the faithful performance of the work, and the other in the amount of one hundred percent (100%) of the Contract price bid to guarantee payment of all claims for labor and materials furnished. This Contract shall not become effective until such bonds are supplied to and approved by the CITY. The Surety Company must have an AM Best rating of A- VII or better.

**4.16 Insurance.**

**4.16.1** CONTRACTOR is also aware of the provisions of Section 3700 of the Labor Code which requires every employer to be insured against liability for Workers' Compensation or undertake self-insurance with provisions of that Code and will comply with such provisions before commencing the performance of the work of this Contract.

**4.16.2** CONTRACTOR and all subcontractors will carry workers' compensation insurance for the protection of its employees during the progress of the work. The insurer shall waive its rights of subrogation against the CITY, its officers, agents and employees and shall issue an endorsement to the policy evidencing same.

**4.16.3** CONTRACTOR shall at all times carry, for all operations hereunder policies of insurance for: (1) bodily injury, including death, and property damage liability insurance; (2) auto liability including mobile equipment if any, for bodily injury and property damage coverage; (3) and builders' all risk insurance. All insurance coverage shall be in amounts specified by CITY in Section 4.16.4 Insurance Requirements. CONTRACTOR shall provide evidence of insurance coverage by the issuance of a certificate of insurance and endorsements in a form prescribed by the CITY. Policies shall be underwritten by insurance companies satisfactory to CITY for all operations, subcontract work, contractual obligations, on-going, products and completed operations, all hired, leased, owned and non-owned vehicles., and mobile equipment if any. Said insurance coverage obtained by the CONTRACTOR, excepting workers' compensation coverage, shall name the CITY, its Officers, Agents, Employees, Engineers, and Consultants for this Contract, and all public agencies from whom permits will be obtained and their Directors, Officers, Agents and Employees, as determined by the CITY, as additional insured on said policies.

For any claims related to this Agreement, CONTRACTOR'S insurance coverage shall be primary insurance as respects CITY, its officers, officials, employees, agents, and volunteers. Any insurance or self-insurance maintained by the CITY, its officers, officials, employees, agents, or volunteers shall by excess of the CONTRACTOR'S insurance and shall not contribute with it

Before CONTRACTOR performs any work at, or prepares or delivers materials to, the site of construction, CONTRACTOR shall furnish certificates of insurance and endorsements evidencing the foregoing insurance coverage and such certificates of insurance and endorsements shall provide the name and policy number of each carrier and that the insurance is in force and will not be canceled without thirty (30) days written notice to the CITY. CONTRACTOR shall maintain all of the foregoing insurance coverage in force until the work under this Contract is satisfactorily and fully completed. The requirement for carrying the foregoing insurance shall not derogate from the provisions for indemnification of CITY by Contractor under Section 4.17 of this Contract. Notwithstanding nor diminishing the obligations of CONTRACTOR with respect to the foregoing, CONTRACTOR shall subscribe for and maintain in full force and effect during the life of this Contract, the following insurance in amounts not less than the amounts specified and issued by a company having a Best's Guide Rate of A-Class VII or better (claims made and modified occurrence policies are not acceptable):

- (a) Commercial general liability in an amount not less than \$1,000,000 per occurrence, including products liability; (**claims**

**made and modified occurrence policies are not acceptable**); Insurance companies must be acceptable to CITY and have an AM Best's Guide Rating of A-, Class VII or better, as approved by the CITY.

- (b) Automobile liability in an amount not less than \$1,000,000 combined single limit; **(claims made and modified occurrence policies are not acceptable)**; Insurance companies must be acceptable to CITY and have an AM Best's Guide Rating of A-, Class VII or better, as approved by the CITY.
- (c) Excess liability coverage shall be provided for any underlying policy that does not meet the insurance requirements set forth herein. **(claims made and modified occurrence policies are not acceptable)** Insurance companies must be acceptable to CITY and have a Best's Guide Rating of A-Class VII or better, as approved by the CITY.

An Additional Insured Endorsement, **ongoing and completed operations, including products liability**, for the policy under section 4.3 (a) shall designate CITY, its officers, officials, employees, agents, and volunteers as additional insureds for liability arising out of work or operations performed by or on behalf of the CONTRACTOR. CONTRACTOR shall provide to CITY proof of insurance and endorsement forms that conform to city's requirements, as approved by the CITY.

An Additional Insured Endorsement for the policy under section 4.3 (b) shall designate CITY, its officers, officials, employees, agents, and volunteers as additional insureds for automobiles owned, leased, hired, or borrowed by the CONTRACTOR. CONTRACTOR shall provide to CITY proof of insurance and endorsement forms that conform to CITY's requirements, as approved by the CITY.

An Additional Insured Endorsement for the policy under section 4.3 (c) shall designate CITY, its officers, officials, employees, agents, and volunteers as additional insureds under the environmental/pollution/asbestos liability policy. CONTRACTOR shall provide to CITY proof of insurance and endorsement forms that conform to CITY's requirements, as approved by the CITY.

For any claims related to this Agreement, CONTRACTOR's insurance coverage shall be primary insurance as respects CITY, its officers, officials, employees, agents, and volunteers. Any insurance or self-insurance maintained by the CITY, its officers, officials, employees, agents, or volunteers shall be in excess of the CONTRACTOR's insurance and shall not contribute with it.

An Additional Insured Endorsement, **ongoing and completed operations**, for the policy under section 4.16.4 (b) shall designate **CITY, its officers, agents, employees, engineers, and consultants** as **additional insureds** for liability arising out of work or operations performed by or on behalf of the CONTRACTOR. CONTRACTOR shall provide to CITY proof of Insurance and endorsement forms that conform to city's requirements, as approved by the CITY.

An Additional Insured Endorsement for the policy under section 4.16.4 (c) shall designate **CITY, its officers, agents, employees, engineers, and consultants** as **additional insureds** for automobiles owned, leased, hired, or borrowed by the CONTRACTOR. CONTRACTOR shall provide to CITY proof of insurance and endorsement forms that conform to CITY's requirements, as approved by the CITY.

For any claims related to this Agreement, CONTRACTOR's insurance coverage shall be **primary** insurance as respects to **CITY, its officers, agents, employees, engineers, and consultants**. Any insurance or self-insurance maintained by the **CITY, its officers, agents, employees, engineers, or consultants** shall be **excess** of the CONTRACTOR's insurance and **shall not contribute** with it.

CITY or its representatives shall at all times have the right to inspect and receive the original or a certified copy of all said policies of insurance, including certificates of insurance and endorsements. CONTRACTOR shall pay all of the premiums on the insurance hereinabove and is required to maintain such insurance coverage during the term of the contract.

- 4.17 Risk and Indemnification.** All work covered by this Contract done at the site of the Project or in preparing or delivering materials to the site shall be at the risk of CONTRACTOR alone. CONTRACTOR agrees to save, indemnify and keep CITY, its Officers, Agents, Employees, Engineers, and Consultants for this Contract, and all public agencies from whom permits will be obtained and their directors, Officers, Agents and Employees harmless against any and all liability, claims, judgments, costs and demands, including demands arising from injuries or death of persons (CONTRACTOR'S employees included) and damage to property, arising directly or indirectly out of the obligations herein undertaken or out of the operations conducted by CONTRACTOR, save and except claims or litigation arising through the sole negligence or sole willful misconduct of CITY and will make good to reimburse CITY for any expenditures, including reasonable attorneys' fees CITY may incur by reason of such matters, and if requested by CITY, will defend any such suits at the sole cost and expense of CONTRACTOR.

#### **4.18 Termination.**

**4.18.1** This Contract may be terminated in whole or in part in writing by the CITY for its convenience, provided that the CONTRACTOR is given (1) not less than ten (10) calendar days written notice (delivered by certified mail, return receipt requested) of intent to terminate, and (2) an opportunity for consultation with the terminating party prior to termination. Termination of contract shall conform to Section 8-1.11 of the State of California, Department of Transportation Standard Specifications.

**4.18.2** If termination for default or convenience is effected by the CITY, an equitable adjustment in the price provided for in this Contract shall be made, but (1) no amount shall be allowed for anticipated profit on unperformed services or other work, and (2) any payment due to the CONTRACTOR at the time of termination may be adjusted to cover any additional costs to the CITY because of the CONTRACTOR'S default. The equitable adjustment for any termination shall provide for payment to the CONTRACTOR for services rendered and expenses incurred in accordance with section 8-1.11 of the State of California, Department of Transportation Standard Specifications.

**4.18.3** Upon receipt of a termination action under paragraph (4.18.1) or (4.18.2) above, the CONTRACTOR shall (1) promptly discontinue all affected work (unless the notice directs otherwise), and (2) deliver or otherwise make available to the CITY all data, drawings, specifications, reports, estimates, summaries and such other information and materials as may have been accumulated by the CONTRACTOR in performing this Contract whether completed or in process.

**4.18.4** Upon termination under paragraphs (4.18.1) and (4.18.2) above, the CITY may take over the work and may award another party an agreement to complete the work under this Contract.

**4.19 Warranty.** The CONTRACTOR agrees to perform all work under this Contract in accordance with the CITY'S designs, drawings and specifications.

The CONTRACTOR guarantees for a period of one (1) year from the date of the notice of completion of the work that the completed work is free from all defects due to faulty materials, equipment or workmanship and that he shall promptly make whatever adjustments or corrections which may be necessary to cure any defects, including repairs or any damage to other parts of the system resulting from such defects. The CITY shall promptly give notice to the CONTRACTOR of observed defects. In the event that the CONTRACTOR fails to make adjustments, repairs, corrections or other work made necessary by such defects, the CITY may do so and charge the CONTRACTOR the cost incurred. The performance bond shall remain in full force and effect through the guarantee period.

The CONTRACTOR'S obligations under this clause are in addition to the CONTRACTOR'S other express or implied assurances provided under this Contract and in no way diminish any other rights that the CITY may have against the CONTRACTOR for faulty materials, equipment or work

- 4.20 Notices.** Any notice required or permitted under this Contract may be given by ordinary mail at the address set forth below. Any party whose address changes shall notify the other party in writing.

To:

- a. (CONTRACTOR)  
iWater, Inc.  
Attention: Don Rhodes, President  
18 Goodyear, Suite 100  
Irvine, CA 92618

- b. (Address of City Purchasing) (with a copy to):

City of Garden Grove  
11222 Acacia Parkway  
Garden Grove, CA 92840

Garden Grove City Attorney  
11222 Acacia Parkway  
Garden Grove, CA 92840

- 4.21. Payment of Taxes:** The contract prices paid for the work shall include full compensation for all taxes which CONTRACTOR is required to pay, whether imposed by Federal, State or local government.

- 4.22 Safety Provisions:** CONTRACTOR shall conform to the rules and regulations established by the California Division of Industrial Safety.

\\ \\ \\

\\ \\ \\

\\ \\ \\

\\ \\ \\

\\ \\ \\

(Agreement Signature Block On Next Page)

**IN WITNESS THEREOF**, these parties have executed this Project Agreement on the day and year shown below.

Date: \_\_\_\_\_

**"CITY"**  
**CITY OF GARDEN GROVE**

By: \_\_\_\_\_  
City Manager

**ATTEST:**

\_\_\_\_\_  
City Clerk

Date: \_\_\_\_\_

**"CONTRACTOR"**  
**iWater, Inc.**

Contractor's State Lic. No. 783766

Expiration Date. 8/31/2014

By: Donald W. Bladen

Title: PRESIDENT

Date: 4/19/2013

Tax ID No. 330906922

If CONTRACTOR is a corporation, a Corporate Resolution and/or Corporate Seal is required. If a partnership, Statement of Partnership must be submitted to the CITY.

**APPROVED AS TO FORM:**

James H. Eggen  
Garden Grove City Attorney

## **ATTACHMENT "A"**

### **SCOPE OF WORK**

#### **IFB No. S-1117**

#### **Provide all Labor and Traffic Control for the operation of 10,300 Water Gate Valves at various locations in the City of Garden Grove**

1. Project Description: The City of Garden Grove Water Services Division is soliciting bids to Exercise/Operate 10,300 Water Gate Valves or Butterfly Valves ranging from 4" to 12" in all Residential streets within the City of Garden Grove.

#### ***The Project consists of the following to be completed by the contractor:***

1. Locate Gate Valve
2. Install gate valve marker (Z-Marker) on curb face
  - Z-Markers, arrows, and bonding agent will be provided by City of Garden Grove.
3. Materials:
  - Gate valve lids will be Yellow color for in line gate valves
  - Fire hydrant gate valve lids will be red color
  - Painted lids will be provided by the City of Garden Grove and the contractor must pick them up prior to each working day
4. The contractor will paint fire hydrants when they operate a fire hydrant gate valve. Contractor will also replace the fire hydrant chains on hydrant caps and replace or install new blue hydrant marker in the street. All materials will be provided by the City of Garden Grove Water Services Division.
5. Vacuum & clean valve box
6. Contractor will use Infra Map Program to document gate valve data
7. Contractor will document gate valve status and be able print to a map form
8. All gate valves will be sub-meter GPS located and recorded
9. All GPS Data will be included and can be added to existing GIS database
10. A schedule will be provide to the Distribution Supervisor and Foreman to operate the gate valves in the water system



**Project Status:** Contractor will make contact with the Water Services Supervisor or Forman for daily updates on project progress

**Traffic Control:** All traffic delineation must conform to the Work Area Traffic Control handbook (WATCH). A traffic plan must be submitted to City of Garden Grove Engineering Section for approval for all major intersection delineation

**License/Certifications:** Contractor shall provide all necessary licenses to do required work for this project. All personnel that work for the contractor must have Distribution 1 Certification and the crew leader must have a Distribution 3 Certification through California Department of Public Health

**Work Hours:** All work will be done between the hours of 8 a.m. to 4:00 p.m. Any changes to these work hours must be authorized in advance by Distribution Supervisor or Foreman.

**Extra Work:** Any work not included in this scope of work requires advance authorization from the Supervisor.

**Job Completion:** Total work will not to exceed 24-month schedule

**SECTION 2 - PROPOSAL**

THE HONORABLE MAYOR AND CITY COUNCIL  
CITY OF GARDEN GROVE  
11222 ACACIA PARKWAY  
GARDEN GROVE, CALIFORNIA 92840

To: THE HONORABLE MAYOR AND CITY COUNCIL

The undersigned having carefully examined the Plans and Specifications to Provide All Labor and Traffic Control for the operation of 10,300 Water Gate Valves at various locations in the City of Garden Grove. HEREBY PROPOSE to furnish all labor, and traffic control, and do all the work required to complete work in accordance with the Plans and Specifications for the sum of:

|   |            |
|---|------------|
| <b>Total Cost of Project In Written Words</b>   |            |
| Five hundred ninety seven thousand and four hundred   |            |
| <b>Lump Sum for All Locations</b>   | \$ 597,400 |
| The above bid price includes all applicable taxes for the pricing proposed in this submittal. |            |
| <b>Note:</b> In case of discrepancy between the words and figures, the words prevail.         |            |

It is understood and agreed that:

- (a) No verbal agreement or conversation with any officer, agent or employee of CITY, either before or after the execution of the Agreement shall affect or modify any of the terms or obligations of this Proposal.
- (b) CITY will not be responsible for any errors or omissions on the part of the undersigned in making up his bid, nor will bidders be released on account of errors.
- (c) The undersigned hereby certifies that this Proposal is genuine and is not sham or collusive, or made in the interest or in behalf of any person not herein named, and that the undersigned has not directly or indirectly induced or solicited any other bidder to put in a sham bid, or any other person, firm or corporation to refrain from bidding, and that the undersigned has not in any manner sought, by collusion, to secure for himself an advantage over any other bidder.
- (d) The Bidder acknowledges receipt of amendments to the Solicitation and related documents numbered and dated:

Amendment No.

Date

\_\_\_\_\_

\_\_\_\_\_



(e) The undersigned is licensed in accordance with the Laws of the State of California.

Check below where appropriate:

☐ Partnership: That \_\_\_\_\_ are partners, doing  
(Names of all Partners)

business under the firm name of \_\_\_\_\_ and that  
the co-partnership makes the accompanying proposal.

☒ Corporation: That Don Rhodes of iWater, Inc. makes  
(President or Secretary) (Name of Corporation)

the accompanying proposal.

☐ Individual: That \_\_\_\_\_ is the bidder and makes the  
(Name of Individual)  
accompanying proposal.

Date: 3-15-2013

iWater, Inc.  
Company Name

18 Goudy, Suite 100  
Address

IRVINE, CA 92618  
City - State - Zip

949-768-4549  
Telephone

783766  
Telephone

Calif. Contractors Lic. No.

DON RHODES  
Bidder's Name (Please Print)

Donald W. Rhodes  
Authorized Signature

Authorized Signature

# DISTRICT MAP GRID

STANTON

ANAHEIM

ORANGE

WESTMINSTER

SANTA ANA

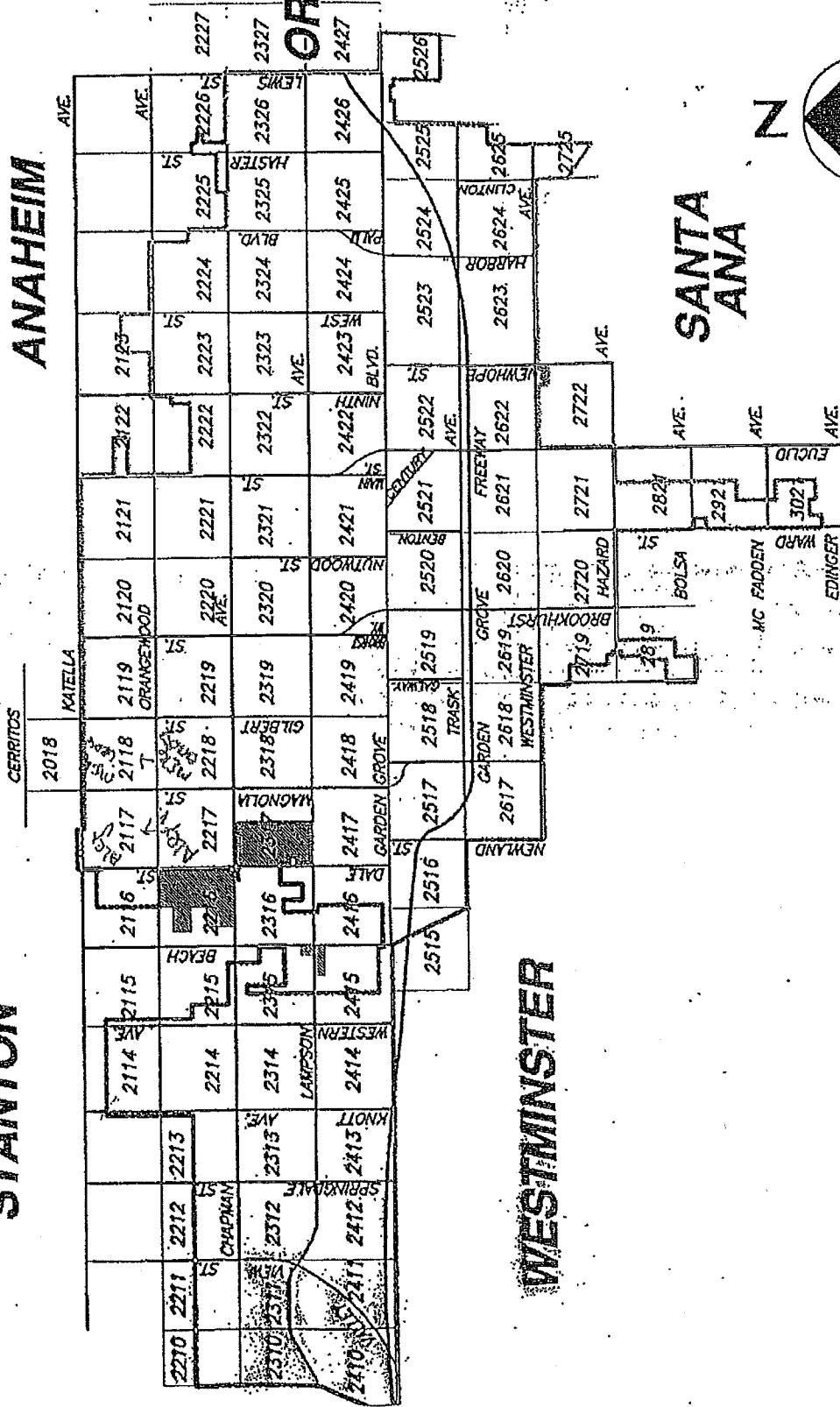

# ORANGE



## (A)

|                   |                     |
|-------------------|---------------------|
| A Better Way      | 2623                |
| Abbey Rd.         | 2525                |
| Abbott Crt        | 2419                |
| Abbott St.        | 2419                |
| Aberdeen Ln.      | 2217                |
| Acacia Ave.       | 2410 2412 2413 2414 |
|                   | 2415 2416 2417 2419 |
|                   | 2421 2424           |
| Acacia Pkwy       | 2421 2422           |
| Acorn St.         | 2221                |
| Adah St.          | 2117                |
| Adams St.         | 2411                |
| Adden Cir.        | 2526                |
| Adeline Ave.      | 2319                |
| Adelle St.        | 2417                |
| Adland St.        | 2520                |
| Adrian Cir.       | 2226 2326           |
| Adrian St.        | 2426                |
| Aero Dr.          | 2317                |
| Agnes Stanley St. | 2417                |
| Alamitos Wy       | 2418                |
| Alan Wy           | 2520                |
| Alderson Ave.     | 2121                |
| Aldgate Ave.      | 2119 2120           |
| Allard Ave.       | 2325 2326           |
| Allen Dr.         | 2320 2321           |
| Almondine Dr.     | 2413                |
| Alonzo Cook St.   | 2411                |
| Alwick Cir.       | 2118                |
| Alwood Ave.       | 2319                |
| Amber Cir.        | 2821                |
| Amethyst Cir.     | 2312                |
| Amethyst St.      | 2212 2412           |
| Amy Ave.          | 2310 2312 2313      |
| Anabel Ave.       | 2622 2623 2625      |
| Anaconda Ave.     | 2314                |
| Anchor Ave.       | 3021                |
| Andrew Dr.        | 2622                |
| Andy Reese Ct.    | 2520                |
| Angus Crt.        | 2217                |
| Anita Pl.         | 2622                |
| Ann Cross Dr.     | 2417                |
| Ansell Ct.        | 2517                |
| Annette Cir.      | 2426                |
| Anthony Ave.      | 2410 2411 2412      |
|                   | 2413 2415 2417      |
| Antigua Ct.       | 2420                |
| Anzio St.         | 2326                |
| Apricot Ln.       | 2322                |
| Arbor Court       | 2421                |

|                 |      |
|-----------------|------|
| Ardis Dr.       | 2218 |
| Aristocrat Ave. | 2417 |
| Arkley Dr.      | 2320 |
| Arlene Ave.     | 2319 |
| Arlotta Cir.    | 2426 |
| Arrowhead St.   | 2316 |
| Artcraft Ave.   | 2321 |
| Ascot Dr.       | 2225 |
| Ashwood St.     | 2522 |
| Aspenwood Ave.  | 2426 |
| Aspenwood Ln.   | 2425 |
| Atlantis Wy.    | 2618 |
| Audrey Cir.     | 2426 |
| Avocado Ln.     | 2322 |
| Avolencia Pl.   | 2322 |
| Augusta Dr.     | 2216 |
| Azalea Cir.     | 2220 |

## (B)

|                   |                |
|-------------------|----------------|
| Baggett St.       | 2121 2221      |
| Bailey St.        | 2410 2211 2311 |
| Balboa Ave.       | 2326           |
| Balfour Cir.      | 2526           |
| Bailard Dr.       | 2120           |
| Ballast Ave.      | 3021           |
| Balos Dr.         | 2516           |
| Bangor St.        | 2325           |
| Banner Ave.       | 2522           |
| Banner Dr.        | 2523           |
| Barbara Ave.      | 2418           |
| Barbette Ave.     | 2921           |
| Barcelona Ct.     | 2421           |
| Barclay Dr.       | 2119 2219      |
| Barker St.        | 2313           |
| Barnett Wy        | 2522 2622      |
| Barney Cir.       | 2621           |
| Barney St.        | 2621           |
| Barr Ln.          | 2317           |
| Bart Dr.          | 2219           |
| Bartlett St.      | 2210 2310 2410 |
| Bayhill Ct.       | 2624           |
| Bayport St.       | 2326           |
| Beach Blvd.       | 2315 2415 2515 |
| Beach Terrace Dr. | 2516 2515      |
| Beacon Ave.       | 3021           |
| Beauxwood St.     | 2226           |
| Becca Dr.         | 2120           |
| Beck Ave.         | 2324           |
| Belfast Dr.       | 2519           |
| Belgrave Ave.     | 2310 2311 2312 |
|                   | 2313 2314 2315 |

|                  |                |
|------------------|----------------|
| Belinda Ct.      | 2420           |
| Bentley Ave.     | 2315           |
| Benton St.       | 2520 2521      |
| Berkshire Wy.    | 2622           |
| Bestel Ave.      | 2516 2517 2518 |
| Beta Ave.        | 2323           |
| Bettes Pl.       | 2120           |
| Betty Ln.        | 2322           |
| Beverly Ln.      | 2319           |
| Bewely St.       | 2624           |
| Bickley Cir.     | 2118           |
| Binnacle Ave.    | 2226           |
| Biola Ln.        | 2518           |
| Birchwood St.    | 2522           |
| Bird Cir.        | 2819           |
| Biscayne Blvd.   | 2119           |
| Biscayne Crt.    | 2119           |
| Bishop Pine Ln.  | 2625           |
| Bixby Ave.       | 2318 2319 2320 |
| Bixler Cir.      | 2222           |
| Bixler Dr.       | 2222           |
| Blackbird St.    | 2524           |
| Blackmer St.     | 2210 2310 2410 |
|                  | 2211 2311 2411 |
| Blackthorn St.   | 2420           |
| Blades Ave.      | 2214           |
| Blake Ave.       | 2619           |
| Blake St.        | 2620 2621      |
| Blanche Ave.     | 2318           |
| Blossom Ave.     | 2317           |
| Bluebell Ave.    | 2224           |
| Bluejay Ln.      | 2219           |
| Bluespruce Ave.  | 2425 2426      |
| Bollvar Cir.     | 2525           |
| Bolivar Pl.      | 2525           |
| Bolsa Ave.       | 2819 2821 2921 |
| Bonnie Dr.       | 2520           |
| Bonser Ave.      | 2320           |
| Boony Ln.        | 2720           |
| Bordeaux St.     | 2625           |
| Bowen Cir.       | 2620           |
| Bowen St.        | 2520 2620 2720 |
| Bowles Ave.      | 2117           |
| Boyd Ave.        | 2617           |
| Bradford Meadows | 2719           |
| Brady Wy.        | 2414           |
| Brandywyne Terr. | 2719           |
| Breezway Dr.     | 2624           |
| Brightwood Ln.   | 2413           |
| Brock Ln.        | 2625           |
| Brookdale Dr.    | 2517           |

|                     |           |
|---------------------|-----------|
| Brookhaven Park Dr. | 2320      |
| Brookhaven St.      | 2220      |
| Brookhurst St.      |           |
| Brookhurst Wy.      | 2419 2420 |
| Brookshire Ave.     | 2323      |
| Brookside Dr.       | 2120      |
| Browning Rd.        | 2320      |
| Brownlee Rd.        | 2220      |
| Buaro St.           | 2324 2424 |
| Buccaneer Cir.      | 2523      |
| Buckingham Cir.     | 2225      |
| Buena St.           | 2725 2625 |
| Buena Wy.           | 2525 2625 |
| Burns Dr.           | 2322      |
| Bushard St.         | 2719 2819 |
| Business Cntr Park  | 2721      |

(C)

|                   |                     |
|-------------------|---------------------|
| Cadet Ave.        | 2325                |
| Calico Ave.       | 2317                |
| Cambridge Meadows | 2719                |
| Camden Meadows    | 2719                |
| Camelia Wy.       | 2222                |
| Canary Ln.        | 2219                |
| Candy Ln.         | 2223 2224           |
| Cannery St.       | 2517 2518           |
| Canter Cir.       | 2213                |
| Canter St.        | 2313 2413           |
| Canterbury Ln.    | 2318                |
| Capital Ave.      | 2721                |
| Capri Dr.         | 2219                |
| Cardinal Ave.     | 2625                |
| Cardinal Cir.     | 2623                |
| Carl Ln.          | 2518                |
| Carlotta St.      | 2213                |
| Carol Ln.         | 2220 2221           |
| Caroleen Ln.      | 2119 2219           |
| Carousel Cir.     | 2410                |
| Carthay Cir.      | 2319                |
| Casa Linda Ln.    | 2418 2518           |
| Casper St.        | 2310 2410           |
| Catalina St.      | 2821                |
| Catherine Ave.    | 2318 2319 2316      |
| Cedar Cir.        | 2419                |
| Cellini Ave.      | 2218                |
| Center St.        |                     |
| Central Ave.      | 2516 2518 2519 2520 |
| Century Blvd.     | 2521                |
| Cerulean Ave.     | 2410 2411 2412 2413 |

Cerulean Dr. 2416  
 Chaparral Dr. 2425  
 Chapman Ave.  
 Charlene Cir. 2319  
 Chase St. 2411 2312  
 Chatenay Wy. 2413  
 Chelsea Cir. 2225  
 Cherry Ln. 2617  
 Chester Ave. 2423  
 Chestnut Ct. 2420  
 Chili Pepper Ln. 2322  
 Choisser Rd. 2325 2425  
 Christal Ave. 2410  
 Christine Ln. 2319  
 Citriadora Crt. 2413  
 Citruswood Ave. 2325  
 Civic Center Dr. 2422  
 Clarissa St. 2121  
 Claussen St. 2421  
 Cliffwood Ave. 2224  
 Clinton St. 2524 2624 2525

2625 2725  
 Clover Ln. 2218  
 Cluster Pines Rd. 2413  
 Coast St. 2516 2515  
 Cobblecreek Dr. 2624  
 Cobblestone Ln. 2622  
 Cockatoo Ln. 2219  
 Cole St. 2319  
 Coleman Pl. 2521  
 College Ave. 2422 2424  
 College St. 2418  
 Columbus Ave. 2517  
 Commerce Dr. 2721  
 Comstock Rd. 2323  
 Converse Howe Cir. 2411  
 Coral Gum Crt. 2413  
 Cork St. 2519 2619 2719 2819  
 Cornwall St. 2221  
 Corporate Dr. 2721  
 Corsair Cir. 2523  
 Cortez Ave. 2517  
 Corvette St. 2318  
 Cottonwood Ave. 2522  
 Country Ln. 2621  
 Coventry Meadows 2719  
 Creek View Dr. 2517  
 Crescent Cir. 2411  
 Crestwood Cir. 2419  
 Crissey Wy. 2222  
 Crosby Ave. 2518 2519 2520 2522  
 Cunningham Ln. 2318

Cynthia Ave. 2622 2625  
 Cynthia Cir. 2622  
 Cypress St. 2520 2620

(D)

Dade Ln. 2120  
 Dakota Ave. 2517 2518 2519 2520  
 Dale St. 2116 2216 2316 2416  
 2117 2217 2317 2417  
 Dallas Dr. 2120  
 Danberry Dr. 2221  
 Daniel Ave. 2223  
 Danvers Dr. 2413  
 Dapplegray Rd. 2523  
 Darnell St. 2324  
 Daryl Ln. 2224  
 David Webster Cir. 2411  
 Davit Ave. 2921  
 Davmore Ave. 2117  
 Dawn Ave. 2326  
 Dawson St. 2620  
 Deanann Pl. 2520 2720  
 Debbie Ln. 2224  
 Della Ln. 2222  
 Delta St. 2323  
 Deodara Dr. 2618  
 Desmond St. 2118 2218  
 Dessa Dr. 2422  
 Detra Ln. 2425  
 Devon Ln. 2517  
 Dewey Dr. 2117 2118 2119 2120  
 Diamond St. 2212 2312  
 Diane St. 2321  
 Dieppe St. 2625  
 Dino Cir. 2121  
 Dino Pl. 2221  
 Dilmore Dr. 2317  
 Doig Dr. 2214  
 Dolan St. 2121 2221  
 Donald Reed Ln. 2321  
 Donegal Dr. 2519 2719 2819  
 Donna Ln. 2223  
 Dorada Ave. 2423  
 Doris Ave. 2220  
 Dorothy Ave. 2521  
 Dottie Cir. 2418  
 Dove Ct. 2420  
 Downey Pl. 2525 2526  
 Downing St. 2324  
 Dozier Dr. 2520



|              |      |
|--------------|------|
| Drake St.    | 2517 |
| Dudman Ave.  | 2312 |
| Dudman Dr.   | 2317 |
| Dumont St.   | 2413 |
| Dungan Ln.   | 2424 |
| Dunklee Ave. | 2426 |
| Dunklee Ln.  | 2424 |
| Dunstan Ln.  | 2520 |

(E)

|                  |           |
|------------------|-----------|
| Eagle Dr.        | 2414      |
| Earle Dr.        | 2518      |
| Easy Wy          | 2221      |
| Eclipse Ct.      | 2420      |
| Eden Cir.        | 2310      |
| Edgebrook Dr.    | 2517      |
| Edgemont Ln.     | 2413      |
| Edgewood Cir.    | 2220      |
| Edgewood Ln.     | 2220      |
| Edieth Dr.       | 2419      |
| Edison Wy        | 2314      |
| Edward Ware Ave. | 2411      |
| Edwina Ln.       | 2418      |
| Egham Cir.       | 2225      |
| Eighth St.       | 2422      |
| Eleanor Dr.      | 2120      |
| Eleventh St.     | 2719      |
| Elizabeth Ln.    | 2421      |
| Elizabeth Pl.    | 2521      |
| Elizabeth St.    | 2221      |
| Ellen St.        | 2321      |
| Ellery Ln.       | 2219      |
| Elliott Pl.      | 2617      |
| Elmer Ln.        | 2117      |
| Elmwood St.      | 2322 2522 |
| El Prado Ave.    | 2426      |
| El Rancho Pl.    | 2424      |
| El Rey Pl.       | 2424 2425 |
| Emerald St.      | 2212 2312 |
| Emerson Ave.     | 2520      |
| Emerson Cir.     | 2517 2312 |
| Emrys Ave.       | 2424      |
| Enault Ln.       | 2317      |
| Endry St.        | 2119      |
| Eneo Pl.         | 2319      |
| Enloe Ave.       | 2617      |
| Enloe Wy.        | 2618      |
| Enterprise Dr.   | 2624      |
| Epsilon St.      | 2323      |

|                   |           |
|-------------------|-----------|
| Erin Rd.          | 2519 2719 |
| Erin St.          | 2619      |
| Ernest Fulsom Dr. | 2417      |
| Estock Dr.        | 2325      |
| Euclid St.        |           |
| Eudora Ln.        | 2223      |
| Eugene St.        | 2224      |
| Eugene Tobias Dr. | 2322      |
| Evergreen Meadows | 2216      |

(F)

|                  |                     |
|------------------|---------------------|
| Fagan Pl.        | 2516                |
| Fairchild St.    | 2210 2310 2410      |
| Fairview St.     | 2525 2625 2526      |
| Falcon Ln.       | 2325                |
| Fallingleaf Cir. | 2225                |
| Fallingleaf St.  | 2325                |
| Faun Ln.         | 2218                |
| Faye Ave.        | 2120 2220 2320      |
| Fern St.         | 2416                |
| Ferndale Dr.     | 2517                |
| Fernwood Dr.     | 2621                |
| Ferrari Ln.      | 2218 2318           |
| Ferris Ln.       | 2218                |
| Fieldgate St.    | 2315                |
| Fieldstone Ln.   | 2413                |
| Fifteenth St.    | 2720                |
| Figueroa St.     | 2624                |
| Firebrand Cir.   | 2225 2425           |
| Firebrand St.    | 2325                |
| Flagstone Ave.   | 2524                |
| Flagstone Pl.    | 2524                |
| Flamingo Dr.     | 2219                |
| Flanner Ave.     | 2120                |
| Fletcher Dr.     | 2420                |
| Fletcher St.     | 2519                |
| Flint Cir.       | 2524                |
| Flint Pl.        | 2524                |
| Florence Ln.     | 2218                |
| Flower St.       | 2420 2520 2620 2720 |
| Flynn Ln.        | 2120                |
| Fondren St.      | 2526                |
| Forbes Ave.      | 2721                |
| Forest Dr.       | 2425                |
| Forsyth Ln.      | 2719                |
| Fostoria St.     | 2122                |
| Fraley St.       | 2119                |
| Frances Ave.     | 2521 2522           |
| Frederick Dr.    | 2322 2323           |
| Frieda Pl.       | 2321                |
| Fulmer Dr.       | 2121                |

## (G)

|                    |   |
|--------------------|---|
| Gail Ln.           | 2223  |
| Gaines Cir.        | 2621  |
| Galway St.         | 2419 2518 2519  |
| Gamble Ave.        | 2119  |
| Gamma St.          | 2323  |
| Garden Dr.         | 2120 2220   |
| Gardenaire Ln.     | 2119  |
| Garden Grove Blvd. |   |
| Garnet Cir.        | 2212 2312   |
| Garnet St.         | 2412  |
| Garo Ln.           | 2617  |
| Gary St.           | 2221  |
| Gaylord Dr.        | 2222  |
| Geneva Ln.         | 2320  |
| George Reyburn Rd. | 2411  |
| George St.         | 2323 2423   |
| Geraldine Cir.     | 2120  |
| Geraldine Rd.      | 2220 2221   |
| Gilbert St.        | 2118 2218 2318 2418<br>2518 2119 2219 2319<br>2419 2519 |
| Gill Dr.           | 2118  |
| Glen St.           | 2323 2423   |
| Glen Wy.           | 2520  |
| Glencove Dr.       | 2522 2523   |
| Glendon St.        | 2525  |
| Glendora St.       | 2620  |
| Glenhaven Dr.      | 2621  |
| Gloria Ave.        | 2517  |
| Gloria St.         | 2525  |
| Granada Ct.        | 2421  |
| Grand Meadows      | 2720  |
| Granite Cir.       | 2524  |
| Granite Pl.        | 2524  |
| Greentree Ave.     | 2325 2326   |
| Green Valley Ln.   | 2417  |
| Greenwillow Dr.    | 2413  |
| Gregory Ln.        | 2421  |
| Grouse Crt.        | 2219  |
| Grove Ave.         | 2421  |
| Groveview St.      | 2320 2420   |
| Gunther St.        | 2624  |

## (H)

|                    |                             |
|--------------------|-----------------------------|
| Hackamore Rd.      | 2320                        |
| Hala Wy.           | 2622                        |
| Hale Ave.          | 2517                        |
| Hale Cir.          | 2617                        |
| Halekulani Dr.     | 2419                        |
| Halelani Wy.       | 2321                        |
| Halyard Ln.        | 2226                        |
| Hammontree Dr.     | 2520                        |
| Hampton Ave.       | 2324                        |
| Hanna Cir.         | 2220                        |
| Hansa Ct.          | 2420                        |
| Harbor Blvd.       |                             |
| Harcourt Ave.      | 2118                        |
| Harmony Pl.        | 2220                        |
| Harper St.         | 2624                        |
| Harrington St.     | 2720                        |
| Harris St.         | 2221                        |
| Harvey Ln.         | 2318                        |
| Haster St.         | 2225 2325 2425 2226         |
| Havenwood Dr.      | 2522 2622                   |
| Hazard Ave.        | 2719 2819 2720 2721<br>2821 |
| Hazel Ave.         | 2418                        |
| Hazel St.          | 2517 2617                   |
| Healey Ave.        | 2313                        |
| Healey Dr.         | 2318                        |
| Heather Ave.       | 2425                        |
| Heather Cir.       | 2426                        |
| Heidi Cir.         | 2621                        |
| Heidi St.          | 2621                        |
| Helene Cir.        | 2310                        |
| Helene St.         | 2410                        |
| Henderson Ave.     | 2921                        |
| Henry Evans Dr.    | 2322                        |
| Heritage Wy        | 2521                        |
| Hermosa Ct.        | 2420                        |
| Hester Pl.         | 2319                        |
| Hewitt Ln.         | 2617                        |
| Hewitt Pl.         | 2617                        |
| Hibiscus Dr.       | 2219                        |
| Hidden Village Rd. | 2320                        |
| Hidden Way         | 2419                        |
| Hill Rd.           | 2220                        |
| Hilton Ln.         | 2426 2526                   |
| Hitchcock Ln.      | 2520                        |
| Hoggan Ave.        | 2324                        |
| Holland Ave.       | 2310                        |
| Holly Dr.          | 2321                        |
| Holyoak Ln.        | 2224                        |

|                 |                |
|-----------------|----------------|
| Homestead Pl.   | 2423 2424      |
| Homeway Dr.     | 2118           |
| Honold Cir.     | 2114           |
| Hope St.        | 2520 2620 2720 |
| Hopi Rd.        | 2216 2217      |
| Howard Cir.     | 2621           |
| Howard St.      | 2621           |
| Huber St.       | 2119           |
| Hummingbird Ln. | 2219           |
| Hunt Ave.       | 2214           |
| Huntley Ave.    | 2310 2311 2312 |

(I)

|               |                |
|---------------|----------------|
| Impala Ct.    | 2420           |
| Imperial Ave. | 2516 2517 2518 |
|               | 2519 2520 2521 |
| Industry St.  | 2314 2414      |
| Ingram Ave.   | 2618 2619      |
| Iris Dr.      | 2322           |
| Ivanhoe St.   | 2120           |
| Ivy Glen Ln.  | 2417           |

(J)

|               |                |
|---------------|----------------|
| Jacalene Ln.  | 2123 2223 2323 |
| Jack Rd.      | 2318           |
| Jackson St.   | 2416 2516 2624 |
| Jade St.      | 2312           |
| James Ave.    | 2625           |
| Jane Dr.      | 2419           |
| Janet Cir.    | 2319           |
| Janet Ln.     | 2424           |
| Janet St.     | 2324           |
| Janette Ln.   | 2223 2323      |
| Jason Ct.     | 2517           |
| Jasper St.    | 2212 2312      |
| Jefferson St. | 2416 2516      |
| Jennifer Ln.  | 2223 2323      |
| Jennrich Ave. | 2720 2721      |
| Jenny Ln.     | 2220 2221      |
| Jentges Ave.  | 2324           |
| Jerome Ln.    | 2418           |
| Jerome St.    | 2318           |
| Jerry Ln.     | 2322 2323      |
| Jessica Dr.   | 2521 2721      |
| Jetty Cir.    | 2326           |
| Jetty St.     | 2426           |

|                   |                |
|-------------------|----------------|
| Jewel Ln.         | 2224           |
| Joan Dr.          | 2320           |
| Johannah Ave.     | 2719 2720      |
| John Ave.         | 2323           |
| John Chaffey Cir. | 2411           |
| Jola Ave.         | 2622           |
| Jola Ln.          | 2622           |
| Josephine St.     | 2417           |
| Joy St.           | 2421           |
| Joyzelle Dr.      | 2117 2118 2119 |
| Judy Ln.          | 2318           |
| Juliana Ln.       | 2320           |
| June St.          | 2224           |

(K)

|                |                     |
|----------------|---------------------|
| Katella Ave.   | 2117 2018 2118      |
|                | 2119 2120 2121      |
| Kathy Ln.      | 2123 2223 2323 2423 |
| Katy Ln.       | 2320                |
| Kearney Wy.    | 2222                |
| Kedge Ave.     | 3021                |
| Keel Ave.      | 2721 2725           |
| Keelson Ave.   | 2921                |
| Kelly St.      | 2517                |
| Kellogg Wy.    | 2518                |
| Kensington Ln. | 2420                |
| Kern Ave.      | 2719 2720 2721      |
| Kerry St.      | 2519 2719           |
| Ketch St.      | 2821                |
| Killarney Ave. | 2411 2412 2413      |
| Killarney Rd.  | 2416                |
| Kim Wy.        | 2224                |
| Kiwi Ln.       | 2516                |
| Knollcrest Ln. | 2413                |
| Knott St.      | 2114 2213 2214 2313 |
|                | 2314 2413 2414      |
| Kona Ln.       | 2419                |

## (L)

|                 |                                  |
|-----------------|----------------------------------|
| La Bonita Ave.  | 2622                             |
| La Dona Ave.    | 2221                             |
| La Dona Dr.     | 2221                             |
| La Grand Ave.   | 2117 2118                        |
| Laguna St.      | 2326                             |
| Laird St.       | 2526                             |
| La Jolla Plaza  | 2619                             |
| Lake St.        | 2721                             |
| Lake Knoll Ave. | 2517                             |
| Lakeside, North | 2421                             |
| Lakeside, South | 2421                             |
| Lakeview Dr.    | 2624                             |
| La Linda Cir.   | 2317                             |
| Lambert Cir.    | 2319 2419                        |
| Lamplighter St. | 2213 2313 2413                   |
| Lampson Ave.    |                                  |
| Lanakila Ln.    | 2419                             |
| Laney Crt.      | 2120                             |
| Lanning St.     | 2622                             |
| Laramore Ln.    | 2526                             |
| Lariat Ave.     | 2617                             |
| Larkin Dr.      | 2119                             |
| Larson Ave.     | 2515 2516 2517<br>2518 2519 2520 |
| Laurel St.      | 2524 2624                        |
| Laurelton Ave.  | 2310 2311 2312<br>2313 2315      |
| Laurianne Ln.   | 2118                             |
| Laux Ave.       | 2425                             |
| Laux Cir.       | 2426                             |
| La Vaughn Dr.   | 2518                             |
| La Vaughn St.   | 2618                             |
| Lavendar Ln.    | 2222                             |
| Lavina Ln.      | 2318                             |
| Law Dr.         | 2320                             |
| Le Ann Dr.      | 2322                             |
| Leda Ln.        | 2424 2524                        |
| Lee Ln.         | 2322                             |
| Leilani Cir.    | 2321                             |
| Lemonwood Ln.   | 2423 2523                        |
| Lenore Ave.     | 2411 2412 2413                   |
| Lenore Dr.      | 2418 2419                        |
| Lenore St.      | 2416                             |
| Leonhardt Cir.  | 2219                             |
| Leota Ln.       | 2224                             |
| Leroy Ave.      | 2418                             |
| Leroy St.       | 2418                             |
| Lesley St.      | 2321                             |
| Lewis St.       | 2326 2426 2526                   |

|                    |                |
|--------------------|----------------|
| Lexington Ave.     | 2819           |
| Libby Ln.          | 2622           |
| Lida Ln.           | 2122           |
| Lilly St.          | 2525           |
| Lincoln St.        | 2521           |
| Lincoln Way        | 2114           |
| Linda Ln.          | 2422           |
| Lindaloe Ln.       | 2122           |
| Lindy Way          | 2617           |
| Linmar Meadows     | 2216           |
| Linnell Ave.       | 2621 2625      |
| Linnert St.        | 2618           |
| Lionhead Ln.       | 2719           |
| Livingston Meadows | 2719           |
| Loara St.          | 2122 2222      |
| Lockhaven Wy       | 2120           |
| Lola Ln.           | 2720           |
| Lomay Ave.         | 2617           |
| Lombardy Rd.       | 2621           |
| Longden St.        | 2412           |
| Loreleen St.       | 2218 2318 2418 |
| Loretta Cir.       | 2319           |
| Lori Ln.           | 2526           |
| Lorna St.          | 2417 2617      |
| Louise Cir.        | 2417           |
| Louise Ln.         | 2417           |
| Louise St.         | 2317 2417      |
| Lucille Ave.       | 2418           |
| Lucille St.        | 2517           |
| Luders Ave.        | 2518 2519 2520 |
| Ludlow Ave.        | 2310 2311 2312 |
| Lyndon St.         | 2720           |
| Lynne Dr.          | 2521           |
| Lynwood Pl.        | 2522           |

## (M)

|                |           |
|----------------|-----------|
| Mabee Cir.     | 2418      |
| Mac St.        | 2117 2217 |
| Mac Alpine Rd. | 2217      |
| Mac Duff St.   | 2117 2217 |
| Mac Gill St.   | 2217      |
| Mac Kay Rd.    | 2217      |
| Mac Murray St. | 2117 2217 |
| Mac Nab St.    | 2117 2217 |
| Madison Cir.   | 2819      |
| Madras Pl.     | 2320      |
| Madrid Ct.     | 2421      |
| Magnolia St.   |           |
| Mahalo Cir.    | 2321      |

|                  |      |           |
|------------------|------|-----------|
| Mahalo Wy.       | 2320 | 2321      |
| Main St.         | 2421 | 2521 2422 |
| Malibu St.       | 2622 |           |
| Malinda Ln.      | 2320 |           |
| Mallard Ave.     | 2617 | 2619 2621 |
| Mallard Dr.      | 2620 | 2621      |
| Manley St.       | 2210 | 2310 2410 |
| Mansor Ave.      | 2619 | 2621      |
| Maple Dr.        | 2523 |           |
| Mar Dr.          | 2517 |           |
| Marauder Cir.    | 2523 |           |
| Marble Cir.      | 2524 |           |
| Marble Pl.       | 2524 |           |
| Marchand Ave.    | 2218 |           |
| Margie Ln.       | 2223 |           |
| Marian Dr.       | 2321 |           |
| Marie Ln.        | 2318 |           |
| Marietta Ave.    | 2410 | 2413 2418 |
| Marilyn Cir.     | 2319 |           |
| Marin Wy.        | 2222 |           |
| Marina Way       | 2517 |           |
| Mariners Wy.     | 2624 |           |
| Markev St.       | 2018 |           |
| Markon St.       | 2114 | 2214      |
| Marlene Ave.     | 2318 |           |
| Marlowe Dr.      | 2318 |           |
| Marshall Ln.     | 2421 |           |
| Marty Ln.        | 2526 |           |
| Mary Hill        | 2417 |           |
| Marylee Dr.      | 2217 | 2218      |
| Mast Ave.        | 2821 |           |
| Maureen Dr.      | 2118 | 2119      |
| Maple Dr.        | 2523 |           |
| Maypole Dr.      | 2324 |           |
| Mayrene Dr.      | 2418 |           |
| Mays Ave.        | 2617 | 2618      |
| McClure Ave.     | 2720 |           |
| McDaniel Dr.     | 2120 |           |
| McEnvoy Ln.      | 2526 |           |
| McFadden Ave.    | 2921 | 3021      |
| McKeen St.       | 2521 |           |
| McLeod St.       | 2321 |           |
| McMains St.      | 2618 |           |
| McMichael Dr.    | 2220 |           |
| Meade St.        | 2318 |           |
| Meadowbrook Ave. | 2517 |           |
| Medina Dr.       | 2221 |           |
| Melba Dr.        | 2118 |           |
| Melody Cir.      | 2220 |           |
| Melody Dr.       | 2419 |           |
| Melody Park Dr.  | 2220 |           |

|                  |                     |
|------------------|---------------------|
| Melric Ave.      | 2921                |
| Mercedes Cir.    | 2318                |
| Merello St.      | 2620                |
| Merrill St.      | 2324 2424           |
| Michael Ave.     | 2625                |
| Mickey St.       | 2518                |
| Midwick Pl.      | 2322                |
| Mildred Ave.     | 2520                |
| Mills Rd.        | 2621                |
| Mirage Ave.      | 2719                |
| Mirage Cir.      | 2719                |
| Miranda St.      | 2212                |
| Mistywood Dr.    | 2624                |
| Mitchell Ave.    | 2521                |
| Moana Wy.        | 2321                |
| Mockingbird Crt. | 2321                |
| Molama Cir.      | 2321                |
| Monarch St.      | 2114 2214 2314 2414 |
| Monroe St.       | 2416 2516           |
| Montclair Crt.   | 2118 2218           |
| Montecito Plaza  | 2120                |
| Montlake Dr.     | 2218                |
| Morgan Ln.       | 2123 2223 2323 2423 |
| Morningside Ave. | 2725                |
| Morningside Dr.  | 2720 2721           |
| Morrie Ln.       | 2220 2320           |
| Mossler St.      | 2216                |
| Motz St.         | 2118                |
| Mount Dr.        | 2121                |
| Movius Dr.       | 2320                |
| Mulberry Ln.     | 2413                |
| Munson Rd.       | 2623                |
| Murline Dr.      | 2118                |
| Mustang Dr.      | 2523                |
| Myron Trapp Dr.  | 2322                |

(N)

|                |                |
|----------------|----------------|
| Nadia Way      | 2622           |
| Nadine Cir.    | 2324           |
| Nadine Ln.     | 2424           |
| Nantucket Wy.  | 2317           |
| Nautilus Dr.   | 2624           |
| Nearing Dr.    | 2216           |
| Nelson St.     | 2321 2421 2521 |
| Neptune Crt.   | 2522           |
| Newbedford Wy. | 2317           |
| Newell St.     | 2522           |
| Newhope St.    | 2522 2622 2423 |
|                | 2523 2623      |

Newland St. 2516 2517 2617  
 Newport Ave. 2326  
 Nichols Dr. 2418  
 Nieta Dr. 2323  
 Niland Wy. 2516  
 Niles Dr. 2521  
 Nina Pl. 2522  
 Ninth St. 2222 2322 2422  
 2223 2323 2423  
 Norma Ln. 2223 2323  
 Nutwood St. 2220 2320 2420  
 2221 2321 2421

(O)

Oakdale Dr. 2517  
 Oakwood St. 2322 2522  
 Oasis Ave. 2719  
 Ocean Breeze Dr. 2419  
 Oertly Cir. 2225  
 Oertly Dr. 2325 2425  
 Ohmer Wy. 2418  
 Old Fashion Wy 2221  
 Olive St. 2411  
 Olson Dr. 2118  
 Oma Pl. 2118 2119  
 Ontario Dr. 2518  
 Onyx Cir. 2312  
 Onyx St. 2212  
 Ora Dr. 2322  
 Ora St. 2322  
 Orangewood Ave.  
 Orchard Pl. 2322  
 Orchid Cir. 2220  
 Ord Wy. 2222  
 Orrey Pl. 2720  
 Otis Ave. 2325  
 Overman Dr. 2121  
 Owen St. 2312 2412

(P)

Pala Dr. 2414  
 Paladium Ave. 2321  
 Paladium Cr. 2321  
 Palika St. 2417  
 Palm St. 2424 2524 2425  
 Palma Vista Ave. 2121  
 Palma Vista St. 2122  
 Palmwood Dr. 2120 2220 2121 2221  
 Palmyra Ave. 2321  
 Paloma Ave. 2521 2522 2523  
 Palomar St. 2413  
 Papaya Ln. 2516  
 Par Ln. 2220  
 Park Ave. 2410 2412 2413  
 2415 2420  
 Park Dr. 2422  
 Park Ln. 2120 2220 2320  
 Parkgreen Ln. 2622  
 Parklawn Dr. 2622  
 Parkside Ln. 2622  
 Parkview Ln. 2622  
 Parkway Dr. 2622  
 Parkwood Dr. 2622  
 Parliament Ave. 2120 2121  
 Parsons Pl. 2722  
 Partridge St. 2525 2625  
 Patricia Dr. 2220 2221  
 Patterson Dr. 2114  
 Peacock Cr. 2219 2319  
 Pearce Ave. 2524  
 Pearce St. 2524 2525  
 Pearl St. 2421  
 Penn Ave. 2521  
 Penny Ln. 2525  
 Pentagon St. 2317  
 Pepperdine Ln. 2518  
 Peppertree Ln. 2422  
 Pepperwood Dr. 2422  
 Percheron Rd. 2523  
 Perrin Dr. 2121  
 Persimmons Cir. 2423  
 Phyllis Pl. 2622  
 Pickett Ave. 2312 2313  
 Pickett Ln. 2323  
 Pickwick Ln. 2719  
 Pine St. 2322 2422  
 Pinebrook Dr. 2624  
 Pinehurst Ct. 2422

|                 |                |
|-----------------|----------------|
| Pinion Ct.      | 2625           |
| Pinto Rd.       | 2523           |
| Pioneer Ln.     | 2322           |
| Pizarro Ave.    | 2517           |
| Pleasant Pl.    | 2319 2419      |
| Pleasant St.    | 2521 2721 2821 |
| Poes St.        | 2216           |
| Poindexter Ave. | 2221           |
| Poinsettia Ln.  | 2117           |
| Pollard Dr.     | 2118           |
| Poplar St.      | 2312 2412      |
| Poppy Dr.       | 2322           |
| Portia Cir.     | 2218           |
| Portsmouth Wy.  | 2317           |
| Pratt St.       | 2323           |
| Presidio Wy.    | 2222           |
| Purcell St.     | 2220           |
| Purdy St.       | 2617           |
| Puryear Ln.     | 2224 2324      |
| Pyle Cir.       | 2819           |

(Q)

|                  |      |
|------------------|------|
| Quail Crt.       | 2219 |
| Quartz Cir.      | 2524 |
| Quartz Pl.       | 2524 |
| Quatro Ave.      | 2624 |
| Queen Annes Crt. | 2719 |
| Quiet Path       | 2419 |

(R)

|                |           |
|----------------|-----------|
| Raelyn Pl.     | 2320      |
| Rainbow St.    | 2524      |
| Rainier Crt.   | 2119      |
| Raleigh Ct.    | 2517      |
| Ramona Dr.     | 2522      |
| Ramona Pl.     | 2522      |
| Ramona Wy.     | 2220      |
| Ramsgate Plaza | 2719      |
| Ranchero Ave.  | 2524      |
| Ranchero Pl.   | 2525      |
| Ranchero Wy.   | 2524 2525 |
| Ranney Ave.    | 2620 2621 |
| Raymond Cir.   | 2411      |
| Rea Cir.       | 2319      |
| Reading Ave.   | 2719      |

|                  |                |
|------------------|----------------|
| Reafsnyder Way   | 2322           |
| Redbird St.      | 2525 2625      |
| Reeve St.        | 2921 3021      |
| Regal Ave.       | 2018           |
| Regina Wy.       | 2222           |
| Reva Dr.         | 2222 2223 2224 |
| Rexford Rd.      | 2323           |
| Rhonda St.       | 2821           |
| Riata St.        | 2617           |
| Richmond Ave.    | 2310 2311 2312 |
| Rickey Ave.      | 2123           |
| Ridgely Dr.      | 2620           |
| Roads End Dr.    | 2220           |
| Roan Rd.         | 2523           |
| Robert Ln.       | 2123 2223 2323 |
| Roberta Cir.     | 2525           |
| Roberta Pl.      | 2525           |
| Robyn Crt.       | 2625           |
| Rockinghorse Rd. | 2523           |
| Rocky Ct.        | 2617 2624      |
| Rocksprings Ct.  | 2624           |
| Roger Dr.        | 2322           |
| Romaine Wy.      | 2413           |
| Rosanna Ave.     | 2118           |
| Roselee Dr.      | 2220           |
| Rosewood Dr.     | 2420           |
| Rosita Pl.       | 2622           |
| Roxbury Rd.      | 2323           |
| Roxey Dr.        | 2525 2625      |
| Royal Palm Blvd. | 2218 2219      |
| Rugh St.         | 2121           |
| Rush St.         | 2118           |
| Russell Ave.     | 2518 2519 2520 |
| Russell Cir.     | 2524 2525      |
| Russell St.      | 2519           |
| Rustic Ln.       | 2018           |

## (S)

Sabre Ave. 2819  
 Safford St. 2522 2423  
 Safford St. East 2423  
 Safford St. West 2423  
 Sage St. 2224  
 Sail St. 2821 2921 3021  
 Saint John Dr. 2617  
 Saint Mark St. 2211 2311 2411  
 Salerno St. 2326  
 Salinaz Dr. 2622 2623 2625  
 Salish Ave. 2217  
 Sally St. 2424  
 Samuel Dr. 2223  
 Sandalwood Cir. 2426  
 Sandalwood Ln. 2425  
 Sandra Pl. 2522  
 Sandy Way 2617  
 San Juan Pl. 2622  
 Santa Barbara Ave. 2210 2211 2212 2213  
 Santa Catalina Ave. 2210 2211 2212 2213  
 Santa Gertrudes Ave. 2210  
 Santa Monica Ave. 2210 2212 2213  
 Santa Rita Ave. 2210 2211 2212 2213  
 Santa Rita Cir. 2215  
 Santa Rosalia St. 2315  
 Santor Ct. 2420  
 Sapphire St. 2312  
 Saratoga Dr. 2420  
 Sarco St. 2213  
 Scandia St. 2213 2313 2413  
 School Dr. 2525  
 Schooner Ave. 2821  
 Schrandt Dr. 2322  
 Seaboard Cir. 2623  
 Seacrest Cir. 2220  
 Seacrest Dr. 2220  
 Seneca St. 2413  
 Sennit Ave. 3021  
 Seventh St. 2422  
 Sequoia Ct. 2317  
 Seville Ct. 2421  
 Seventeenth St. (Westm. Ave.)  
 Shackelford Ln. 2418  
 Shady Acre St. 2321  
 Shady Dr. 2625  
 Shadyrock Dr. 2624  
 Shannon Ave. 2218 2219  
 Shappell Ave. 2518  
 Shearer Ln. 2625

Shelley Dr. 2218 2420  
 Sheppard Cir. 2517  
 Sheridan Ln. 2320  
 Sherlock Cir. 2318  
 Sherlock Ln. 2318  
 Sherman Ave. 2521 2522  
 Sherwood 2422  
 Shetland Rd. 2323  
 Shirley St. 2622  
 Sidney Pl. 2221  
 Siemon Ave. 2526  
 Silver Cir. 2821  
 Simmons Ave. 2224 2226  
 Simmon Place 2215  
 Sinclair Cir. 2819  
 Sirius St. 2226  
 Sixteenth St. 2720  
 Skylark Blvd. 2218 2219  
 Skylark Ln. 2219  
 Skywood Dr. 2422  
 Somerset Pl. 2225  
 Songish St. 2120  
 Sorrell Dr. 2523  
 Souza Ave. 2518  
 Spar St. 2921 3021  
 Spencer Dr. 2318  
 Spencer Johnson Pl. 2411  
 Spinnaker St. 2426  
 Spring St. 2411  
 Springdale St. 2212 2312 2412  
 2213 2313 2413  
 Springwater Dr. 2624  
 Spruce St. 2419  
 Stanford Ave.  
 Stanley Ln. 2220 2221  
 Stanrich Pl. 2521  
 Starboard St. 2821 2921 3021  
 Starwood Dr. 2422  
 Steele Dr. 2221  
 Steele St. 2121  
 Steele Wy. 2221  
 Stengel St. 2720  
 Stephanie Ln. 2220  
 Stephens Ave. 2525  
 Stern Ave. 2821  
 Stimson St. 2324  
 Stonegate Ln. 2311  
 Stonehaven Cir. 2418  
 Stratford Wy. 2120  
 Strathmore Dr. 2323 2423  
 Stuart Dr. 2523



Style Dr. 2220  
 Sugar Pine Wy. 2625  
 Summercrest Cir. 2617  
 Summerwood Pl. 2617  
 Sumo Cir. 2423  
 Sungrove Cir. 2225 2425  
 Sungrove St. 2325 2425  
 Sunnybrook Cir. 2517  
 Sunnyvale Ave. 2516  
 Sunswept Ave. 2725  
 Susan Cir. 2419  
 Susan Ln. 2419  
 Sussex Cir. 2225  
 Sutherland Wy. 2719  
 Sutter St. 2413  
 Swallow Ln. 2219  
 Sweetbrier Dr. 2425  
 Sycamore Ln. 2523  
 Sylvan St. 2412

(T)

Tacoma St. 2121  
 Taft St. 2521 2621 2721 2821  
 Tamerlane Dr. 2324  
 Tampion Ave. 2921  
 Taylor Cir. 2312  
 Taylor St. 2412  
 Teal Ave. 2619  
 Teal Dr. 2620 2621  
 Terry Cir. 2320  
 Thackery Dr. 2324  
 Thirteenth St. 2719 2720  
 Tibbs Cir. 2120 2121  
 Tiffany Ave. 2410 2411  
 Tiller Ave. 2226  
 Timber Rd. 2425  
 Timmy Ln. 2224  
 Timothy Ln. 2218  
 Toble St. 2121  
 Topaz Cir. 2212 2312  
 Topaz St. 2312 2412  
 Torrey Pine Ln. 2625  
 Touchstone Ln. 2318  
 Tours Ave. 2625  
 Town & Country Dr. 2218  
 Tracy Ave. 2117  
 Trask Ave.  
 Traylor Wy. 2620  
 Treva Cir. 2617

Trinette Ave. 2410 2411 2412 2413  
 Trinette Dr. 2416 2417  
 Tristan Dr. 2218  
 True Wy. 2222  
 Tudor Ln. 2318  
 Tunstall Cir. 2411  
 Tunstall St. 2410 2211 2311 2411  
 Turquoise St. 2212 2312  
 Tuscany Ct. 2420  
 Twana Dr. 2217  
 Twinleaf Cir. 2425  
 Twinleaf Ln. 2426  
 Twintree Ave. 2324  
 Twintree Cir. 2326  
 Twintree Ln. 2325  
 Tyhurst Rd. 2320

(V)

Valencia Wy. 2418  
 Valley View St. 2410 2211 2311  
 2411 2312 2212  
 Vanguard Ave. 2310 2311 2312  
 Vanguard Cir. 2315  
 Varna St. 2221  
 Vegas Wy. 2220 2221  
 Vener Dr. 2518  
 Vera Cir. 2310  
 Vera St. 2410  
 Verde St. 2519 2719  
 Vic Pl. 2320  
 Vicilia St. 2117 2217  
 Vickers Dr. 2221  
 Vienna Dr. 2421  
 Viking Cir. 2523  
 Village Cntr Dr. 2415  
 Village Rd. 2419  
 Vinevale St. 2118  
 Violet Dr. 2322  
 Volkwood St. 2325 2425  
 Vons Dr. 2118 2119

## (W)

Wakefield Ave. 2122  
 Walnut Ave. 2322 2422  
 Walnut St. 2521  
 Ward St. 2720 2621 2721  
 2821 2921 2021  
 Wasco Rd. 2117 2217  
 Wasco St. 2117 2217  
 Washington Ave. 2819  
 Waterworks Rd. 2322  
 Waverly Dr. 2222  
 Weaver Cir. 2213  
 Weaver St. 2313  
 Weldon Dr. 2418  
 Wentworth Pl. 2622  
 West St. 2123 2223 2224 2323  
 2324 2423 2424  
 Western Ave. 2114 2214 2215 2314  
 2315 2415 2414  
 Westlake St. 2421 2521  
 Westminster Ave.  
 Whittier Ln. 2518  
 Wickham Pl. 2625  
 Wild Goose St. 2213 2313 2413  
 Wilken Wy. 2224  
 Willowood Ave. 2325  
 Wilson St. 2516  
 Windsor Lane 2525  
 Winton St. 2211 2311  
 Woodbridge Dr. 2624  
 Woodbrook Dr. 2516  
 Woodbury Ave. 2619 2623  
 Woodbury Rd. 2620 2621 2622 2625  
 Woodland Ln. 2423  
 Woodward Cir. 2221  
 Woodward Ln. 2221  
 Wooley Ln. 2417  
 Wutzke St. 2213 2313  
 Wynant Dr. 2416 2516

## (Y)

Yana Dr. 2117 2217  
 Yawl St. 2821 2921  
 Yermo Cir. 2819  
 Yoak St. 2618  
 Yockey St. 2517 2617  
 Yorba Ln. 2516  
 Yorkshire Ave. 2217  
 Yucca Ave. 2224

## (Z)

Zeta St. 2323

*Number Streets*

7<sup>th</sup> St. 2422  
 8<sup>th</sup> St. 2422  
 9<sup>th</sup> St. 2222 2223 2322  
 2323 2422 2423  
 11<sup>th</sup> St. 2719  
 13<sup>th</sup> St. 2719 2720  
 15<sup>th</sup> St. 2720  
 16<sup>th</sup> St. 2720 2720  
 17<sup>th</sup> St. (Westminster Ave.)